

ACCOUNT NO. 0001018326

SOLD TO  
Triax Metal Prod Inc  
1880 SW Merlo Drive  
BEAVERTON OR 97006  
US



BIN NUMBER  
0957-4

UPS SHIPPER NO. MN 5-65-685  
SO: 637823-10

SHIP TO  
Triax Metal Prod Inc  
1880 SW Merlo Drive  
BEAVERTON OR 97006  
US

**\*5650415\***

PROD. ORDER # 565-0415  
QNC # 650415

P.O. NUMBER 66686

**05**

W.T. NUMBER	ORDER DATE	TARGET SHIP DATE	CUSTOMER CONTACT	CUSTOMER PHONE and FAX	QUESTIONS CONTACT	TERMS
637823-10	10/30/2008	11/05/2008	Shaun Fitch	PH: 503-649-9500 FAX: 503-649-1888	Kirby Olesen	WT10
SALES NO. A0022	INSTRUCTIONS			SHIP VIA UPS1		

B STN THICK THK LANCE & F/U < 90 B STN (0.375 MAX)

ITEM	QUANTITY	CLEARANCE	CATALOG NUMBER: 12696	ASSEMBLY NUMBER:	SHAPE: SP
1	1				
EJECTOR					

Custom Cell

STATION: 1-1/4 (THK)  
MACH: VIPROS 358  
MAT'L: .030 ST. ST.  
REPLACEABLE PUNCH TIP  
DIE: Ø 3/8 INSERT  
METRIC HARDWARE  
RAD OK  
2x SCALE

CUSTOMER RUNNING WITH  
COMPONENT FROM  
P.O.# 385-5321, 565-0416,  
& 565-0417

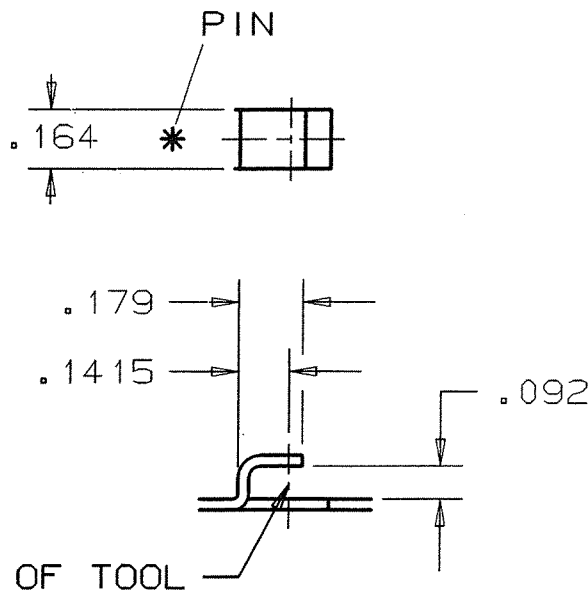

565-0415

**\*\*650415\*\***  
\*650415000025375\*11040724

RC  
P.O.# 565-0415