



Acct# 1018326

Wilson Tool Intl. Plant
12912 Farnham Avenue
WHITE BEAR LAKE, MN 55110
US

Ship Via: UPS Ground
SO: 1046270-10
Prod Ord: 7668782
P.O. Number 79350
Payment Terms Net due in 10 days

Sold To Triax Metal Products LLC
1880 SW Merlo Drive
CharBEAVERTON OR 97006
US

Ship To Triax Metal Products LLC
1880 SW Merlo Drive
BEAVERTON OR 97006
US

Contact: Shaun Fitch Phone: 503-649-9500 Fax: 503-649-1888 Email: shaun@triaxmetal.com

Order Date	Target Ship Date	Question Contact	Instructions
05/02/2013		Mark Wolkerstorfer	
QTY: 1 2257 Thick Lance & Form-Up <90° B Station (>0.375)			
STATION: B STATION (1-1/4)	RELIEF: NO RELIEF	KEYING: STANDARD	MATL: MILD STEEL
STYLE: DETERMINE	AUTO INDX: NO		MATL THK: 0.0600 in
MACHINE: AMADA	AL/HF: NO		MIN MATL: 0.0600 in
MODEL: VIPROS 358			COATING: NO COATING
Item 1 - FULL SET, CLR: 0.0090 in			

RUNS WITH S.O.#: 1046270-20

* THE APPROXIMATE ADJUSTED PUNCH LENGTH IS : 8.012

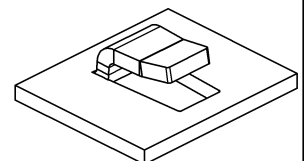
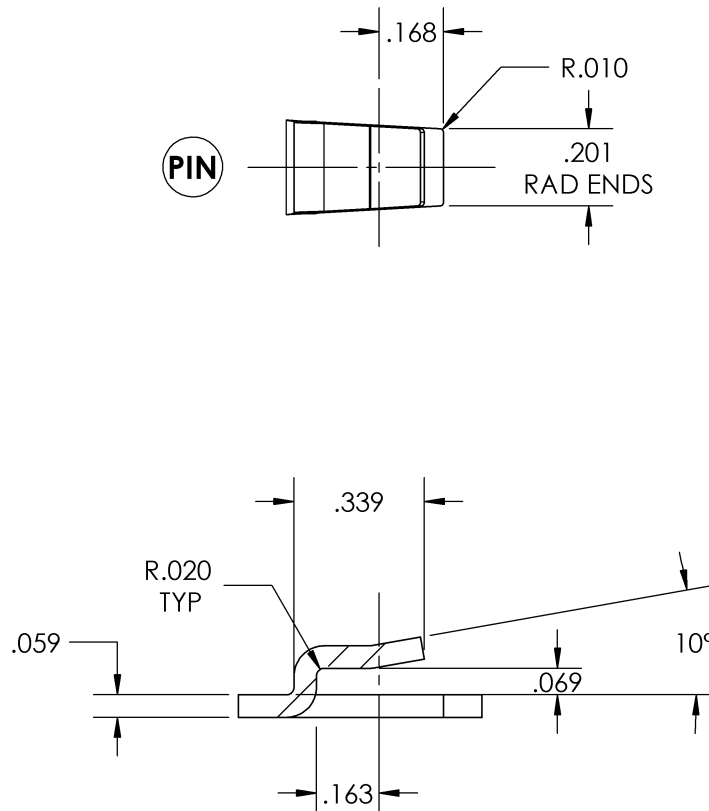

RJB
PROD# 7668782