

1.1/4" THICK F/D BRIDGE LANCE TOOLING

| | | | | |
|--------------|---------------|--------|---------|----------------|
| TOOL NUMBER | CUSTOMER NAME | DWG BY | DATE | MATERIAL INFO. |
| A11441401503 | TRIAX | SG | 3/21/16 | .060 AL |

ET# 16815851
DUE DATE 3/23/16

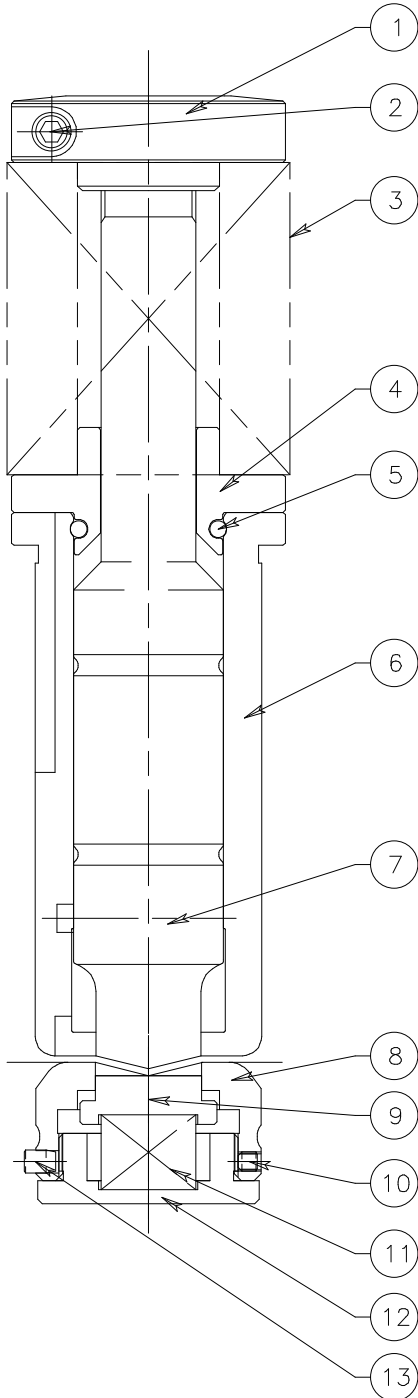
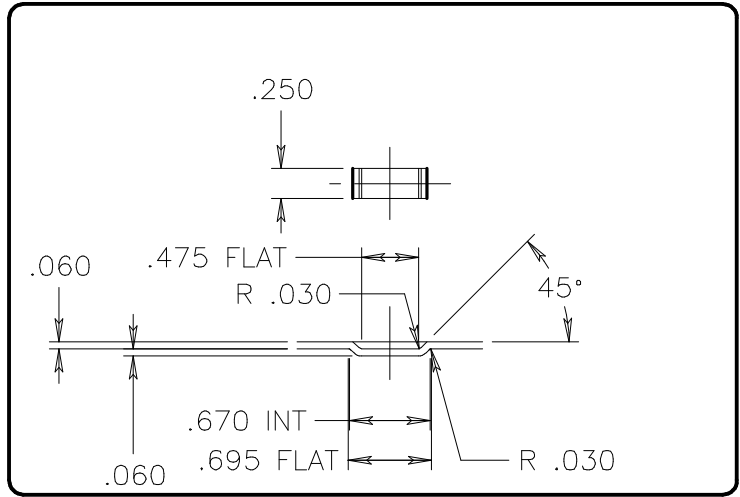

| NO. | PART NUMBER | QTY | DESCRIPTION | SHEET # |
|-----|-------------|-----|-------------------------|---------|
| 1 | 5523502P | 1 | SINGLE PUNCH HEAD (STD) | |
| 2 | 00106020 | 1 | SHCS M6X20 | |
| 3 | 5500131 | 1 | SPRING (STD) | |
| 4 | 5500121 | 1 | SPRING RETAINER (STD) | |
| 5 | 91008K-90 | 1 | O RING P26 (STD) | |
| 6 | 5500081 | 1 | SHAPE GUIDE (STD) | |
| 7 | 5500041 | 1 | SHAPE PUNCH BODY (STD) | |
| 8 | 5518009 | 1 | DIE BODY | |
| 9 | 9100208 | 1 | DIE EJECTOR PIN | |
| 10 | 00504004 | 1 | SET SCREW M4X4 | |
| 11 | 01312020 | 1 | COIL SPRING SWM 12-20 | |
| 12 | 5552105 | 1 | BACK UP PLATE | |
| 13 | 9100209 | 1 | DIE KEY | |

*NOT FOR USE ON MECHANICAL MACHINES